

Flush Washer PURE LED

PROJECT:

TYPE:

SOURCE:

NOTES:

SPECIFICATIONS

IK10 IP67 CE cUL LISTED

LED Chip	Cree CXA 1304 field replaceable LED board
Luminaire Output	600 Lumens @ 700mA (9 watts), Delivered from Luminaire with unobstructed beam.
Lumens Per Watt	66 Lumens minimum @ 9 watts, Delivered from Luminaire with unobstructed beam
CRI (3000K)	80 Standard, 90+ Optional
Colour Temperatures	2700K, 3000K, 4000K
Beam Angles	Asymmetric Wash
Ingress Protection	IP67
Inverse Kinematics Rating	IK10
Maximum Load	2000kgs (4400lbs)
Warranty	Electronics = 5 years Body Cop/SS = 10 years Body Aluminium = 5 years
Standards	BS/EN 60598.2.2, 60598.2.18, 60598.1 cUL 1838, 2108 CE

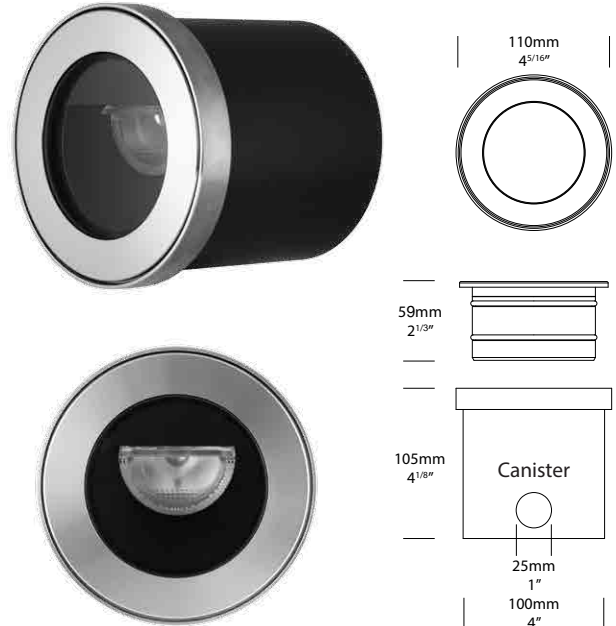

PRODUCT CONFIGURATION

Please fill in appropriate codes into boxes provided

Cat. No. WASH/L

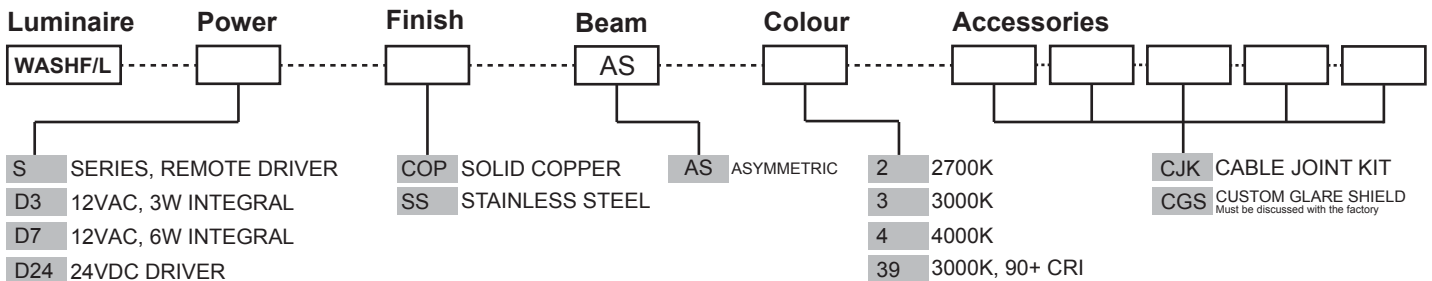

SERIES, REMOTE DRIVER REQUIRED: Constant current driver Individual fixtures require 9vdc @ 700mA maximum.

12VAC INTEGRAL DRIVER: Transformer required
Hunza integrated plug and play driver
Input: 9-15VAC.
Output: 9vdc @ D3=350mA, D7=700mA, limited to ≤ 40°C (104°F) ambient temperature in Stainless Steel)

24VDC DRIVER:
Input: 24vdc.
Output: 18vdc @ 700mA constant current (non dimming).
Note: not for USA.

[Click here for 240v Remote Power Supply Guidance Charts](#)
[Click here for USA Remote Power Supply Guidance Charts](#)

LUMINAIRE CONSTRUCTION

CNC machined from one of the following metals:

Copper:

Body - 88.9mm (3^{1/2}"). Flange - solid copper 115mm (4^{1/2}") rod.

316 Stainless Steel:

Body - 88.9mm (3^{1/2}"). Flange - solid 316 stainless steel 115mm (4^{1/2}")

Step Lens:

10mm (25/64") Extra clear, low iron, shatter resistant glass. Lifetime warranty

Gaskets:

Silicone, iron impregnated 220°C (428°F)

Cable:

Water resistant rubber

Mounting:

The Washer comes with a Flush Mounting PVC canister for casting into the ground, vertical surface or into concrete. Maximum drive over speed 10 kph/h (6mp/h) with a maximum load rating of 2000kgs (4400lbs).

Luminaire Weight:

Stainless Steel 1.7kg (3lbs 12oz)
Solid Copper 1.9kg (4lbs 3oz)

ACCESSORIES

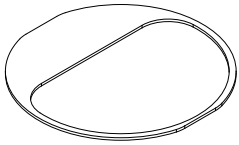

Custom Glare Shield
Must be discussed with the factory

BEAM ANGLES

High efficiency Reflectors. Field replaceable

IES files available for download: hunzalighting.com/downloads

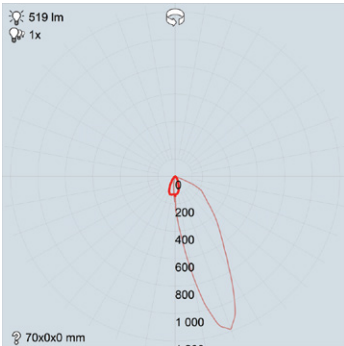

ASYMMETRIC LENS

WIRING GUIDE

Available for download: hunzalighting.com/downloads

Series/remote driver

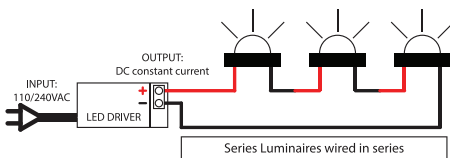

12v integral driver

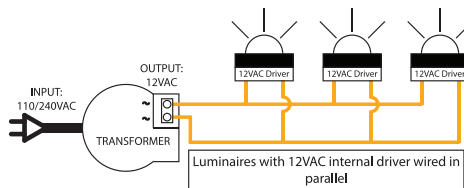

24vdc integral driver

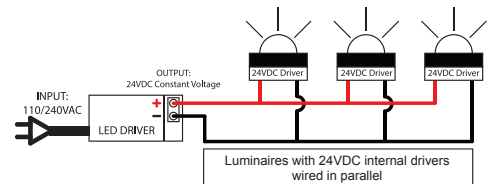

Diagrams are a guide only, wire colours and polarity may change depending on fixture and country

Specifications may change without notification

Aug 2017