

Washer PURE LED

PROJECT:

TYPE:

SOURCE:

NOTES:

SPECIFICATIONS

IK10 IP67 C E cUL US LISTED

LED Chip	Cree CXA 1304 field replaceable LED board
Luminaire Output	600 Lumens @ 700mA (9 watts), Delivered from Luminaire with unobstructed beam.
Lumens Per Watt	66 Lumens minimum @ 9 watts, Delivered from Luminaire with unobstructed beam
CRI (3000K)	80 Standard, 90+ Optional
Colour Temperatures	2700K, 3000K, 4000K
Beam Angles	Asymmetric Wash
Ingress Protection	IP67
Inverse Kinematics Rating	IK10
Maximum Load	2000kgs (4400lbs)
Warranty	Electronics = 5 years Body Cop/SS = 10 years Body Aluminium = 5 years
Standards	BS/EN 60598.2.2, 60598.2.18, 60598.1 cUL 1838, 2108 CE

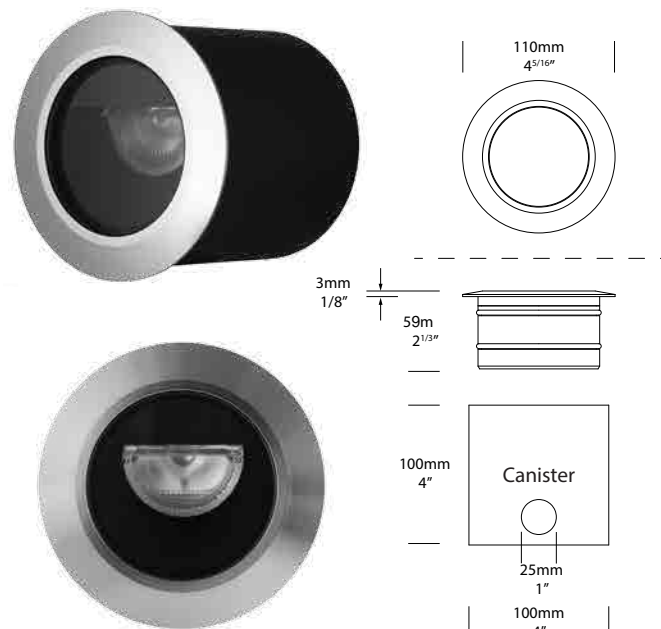

PRODUCT CONFIGURATION

Please fill in appropriate codes into boxes provided

Cat. No. WASH/L

Luminaire	Power	Material/ Finish	Beam	Colour	Accessories
WASH/L			AS		
S SERIES, REMOTE DRIVER D3 12VAC, 3W INTEGRAL D7 12VAC, 6W INTEGRAL		EBK BLACK EBZ BRONZE EGR OLIVE GREEN EWB WHITE EWB WHITE BIRCH EDG DARK GREY ESTAR SILVER STAR ECT CORTEN COP SOLID COPPER SS STAINLESS STEEL	AS ASYMMETRIC	2 2700K 3 3000K 4 4000K 39 3000K, 90+ CRI	CJK CABLE JOINT KIT CGS CUSTOM GLARE SHIELD <small>Must be discussed with the factory</small>

SERIES, REMOTE DRIVER REQUIRED:
Constant current driver
Individual fixtures require 9vdc @ 700mA maximum.

12VAC INTEGRAL DRIVER:
Transformer required
Hunza integrated plug and play driver
Input: 9-15VAC.
Output: 9vdc @ D3=350mA, D7=700mA, limited to ≤ 40°C (104°F) ambient temperature in Stainless Steel)

[Click here for 240v Remote Power Supply Guidance Charts](#)

[Click here for USA Remote Power Supply Guidance Charts](#)

LUMINAIRE CONSTRUCTION

CNC machined from one of the following metals:

Aluminium:

Body - High corrosion resistant 88.9mm (3^{1/2"}) 6061 aluminium. Flange - solid aluminium 115mm (4^{1/2"}) rod, Finished with chromate substrate, Epoxy layer and a UV resistant polyester powder coat colour.

Colours:

Black, Bronze, Silver Star, White, White Birch, Olive Green, Dark Grey, Corten.

Copper:

Body - 88.9mm (3^{1/2"}). Flange - solid copper 115mm (4^{1/2"}) rod.

316 Stainless Steel:

Body - 88.9mm (3^{1/2"}). Flange - solid 316 stainless steel 115mm (4^{1/2"})

Step Lens:

10mm (25/64") Extra clear, low iron, shatter resistant glass.
Lifetime warranty

Gaskets:

Silicone, iron impregnated 220°C (428°F)

Cable:

Water resistant rubber

Mounting:

The Washer comes with a PVC mounting canister for casting into the ground, vertical surface or into concrete.

Maximum drive over speed 10 kp/h (6mp/h) with a maximum load rating of 2000kgs (4400lbs).

Luminaire Weight:

Stainless Steel 1.5kg (3lbs 5oz)

Solid Copper 1.6kg (3lbs 8oz)

Aluminium 1kg (2lbs 3oz)

ACCESSORIES

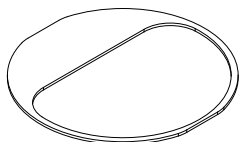

Custom Glare Shield
Must be discussed with the factory

BEAM ANGLES

High efficiency Reflectors. Field replaceable

IES files available for download: hunzalighting.com/downloads

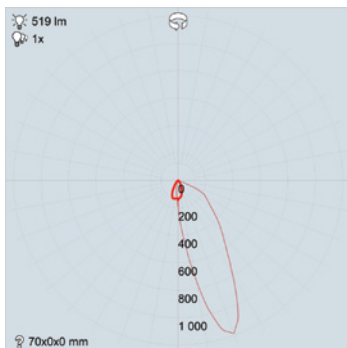

ASYMMETRIC
LENS

WIRING GUIDE

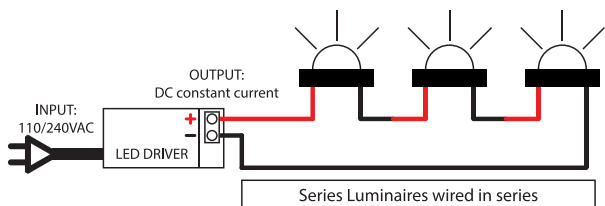

Diagrams are a guide only, wire colours and polarity may change depending on fixture and country

Available for download: hunzalighting.com/downloads

